

OPTIMIZE YOUR JOBSITE.

CARMIX
4x4 mixers & dumpers



- . Carmix DUMPER D6
- . Carmix TRAILER PUMP 15
- . Carmix CARSILOS
- . Carmix BAGGER

CARMIX
EVERYWHERE
YOU BUILD

DUMPER D6

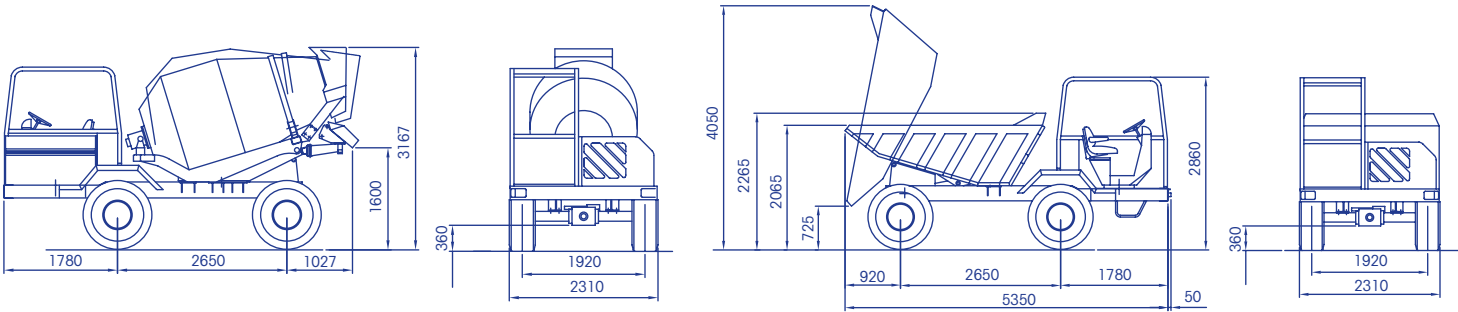

ACCESSORIES
ON DEMAND

Spare wheel

SPECIAL VERSION:
Mixing unit 3.5 interchangeable with dumper bucket:
Mixing unit (drum capacity 4850 l, concrete yield 3,5 m³)
complete with all necessary attachments, hydraulic pumps,
motor and hydraulic controls fitted on the chassis.

**This feature is available only when dumper and mixer
attachment are ordered at the same time.**

DUMPER D6



LOADING CAPACITY: Struck: 4500 liters.
Heaped SAE: 6000 liters.



PAYLOAD: Kg. 10.000



ENGINE: Perkins 1104 D-44 TA Turbo-Diesel, water-cooled, 4 cylinders. Rated power KW 83 (111 HP) set at 2.300 rpm.



TRANSMISSION: Fully hydrostatic Bosch Rexroth with electric inverter. Gear box with mechanic control, two speeds. 4 wheel drive and steering.



AXLES: Dana Spicer with oil bath disc brakes and planetary reducers.



SPEED: Working speed from 0 to 9 km/h. Road transfer from 0 to 25 km/h.



DRIVING SEAT: Reversible seat with automatic inversion of hydraulic steering circuits. ROPS-FOPS (UNI 11023 - ISO 3471) cab closed on 3 sides.



SKIP: Heavy duty rock type. Hydraulic tilting with 2 cylinders.



HYDRAULIC SYSTEM: 2 independent circuits, variable outlet pump for hydrostatic transmission and hydraulic pump for services. Heat exchanger water-oil-air/air type.



BRAKES: Oil bath disc brakes on 4 wheels. Hydraulic parking brake negative on rear axle manually operated.



TYRES: Off road industrial type 16/70-20 14 PR.



STEERING: Hydrostatic, "load sensing" type 3 way steering. Radius: internal 2000 mm. external 3700 mm.



ELECTRIC SYSTEM: 12 volt. 120 Ah battery for electric starter and road lighting. Safety battery cut-off. .



GRADIENT: Fully loaded 30%



TANKS: Diesel: 115 liters. Hydraulic oil: 80 litri.



TANKS: Water: 310 liters. Diesel: 35 liters. Hydraulic oil: 25 liters.



CHASSIS: Steel profile specially engineered for off-road operations.



WEIGHT: About Kg. 5 .800 equally distributed on both axles.



SAFETY: Machine equipped with checking and block valves for maximum safety of the operator.



CATALOGUE: The machine is equipped with Use and Maintenance and Spare Parts Manuals according to CE regulations.

DUMPER D6



CARMIX TRAILER PUMP 15



ACCESSORIES ON DEMAND

TOWING KIT CE FOR ROAD CIRCULATION

CONCRETE PUMPING KIT:

- 07 Steel pipes dn 4" L 3 mt for Victaulic 4"
- 01 Rubber hose 4" L 3 mt for Victaulic 4"
- 01 Steel bends dn 4" r=250/90° Victaulic
- 02 Steel bends dn 4" r=250/45° Victaulic
- 12 Victaulic coupling dn 4"
- 15 Gasket for Victaulic coupling dn 4"
- 02 Cleaning ball dor hose diam. 150/200
- 01 Basket for cleaning ball recovery dn 4"
- 01 90° bend with ball inlet port
- 01 Bend top 100 Victaulic

SHOTCRETING SPRITZBETON KIT:

- 02 rubber hose dn 50 mm , l. 10 m Victualic 2" – Victualic 2"
- 01 rubber hose dn 50 mm , l. 10 m Victualic 2" – cam dn 50
- 01 complete hopper gun dn 50 with fast Geka coupling ¾" for air
- 01 reduction cone dn 100 (4")-dn 50 (2")Victualic l = 1000 m
- 01 hanging belt for hose
- 02 cleaning ball for hose dn. 50
- 01 Victualic coupling dn 4"
- 02 gasket for Victualic coupling dn 4"
- 03 Victualic coupling dn 2"
- 06 gasket for Victualic coupling dn 2"
- 01 gasket for cam coupling dn 50

CARMIX TRAILER PUMP 15

- + 2-cylinder piston pumps, hydraulic driven
- + Ideal for pumping up to 15 m³/h
- + Complete with automatic greasing system
- + Max pumping Height: 60-70 m
- + Max pumping distance: 80-90 m
- + Max aggregate size 25 mm
- + Pumping pressure 70 bar
- + Hopper capacity 240 liters

- Yanmar 31HP 3 Cylinders liquid cooled diesel engine
- Concrete hopper with agitator
- Grid with 12V vibrator
- Pumping unit with S-Tilting valve for automatic compensation of clearance and wear
- EasySpritz system: best pumping performance also at low flow rate
- 4" Victaulic delivery manifold (= 100 mm)
- Control panel with electromechanical devices
- 4-Function wire remote control
- Road-towable unit complete with parking brake and lights (on request)
- Compact and easy to move
- Dimensions: w/l/h: 1495/4100/1540 mm
- Weight: 1550 kg



CARMIX TRAILER PUMP 15





CARSIOLOS

EFFICIENT CEMENT SILOS TO OPTIMIZE YOUR JOBSITE

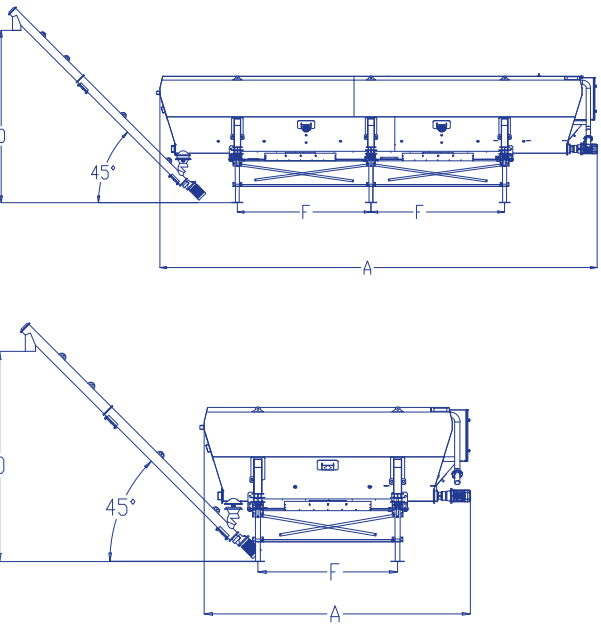

	CARSIOLOS HC 16	CARSIOLOS HC 26	CARSIOLOS HC 36
A	5840	8976	11540
B		2230	
C		2230	
D		4485	
E		3400	
F	3000	4400	3500
G		1220	
H		2920	

All sizes are quoted in mm.

ACCESSORIES ON DEMAND

- Kit CE
- Water plant with 2 water tanks (lt. 1.260 each), pump and water meter
- Wireless remote control start/stop screws conveyor
- Electrical customization

CARSIOLOS



Electronic weighing system with load cells complete with digital instruments and automatic measuring management.



Main frame complete with 4/6 telescopic stabilizers for loading and unloading operations from the truck. No need of other lifting equipment.



Static filter for dust recovery with hopper.



Complete with fluidification system, vibrators and discharging screw conveyor.



Electric control panel complete with additional emergency devices.



Designed to fit 40" box high cube.

CARSIOLOS HC 16 (16 m³)

CARSIOLOS HC 16

TOTAL STORAGE CAPABILITY:	16 m³
THEORYC PRODUCTION:	480 kg/min
EMPTY PLANT WEIGHT:	4100 kg
ABSORBED POWER:	13 kW
THREE-PHASE TENSION FEEDING:	400V, 50Hz

CARSIOLOS HC 26 (26 m³)

CARSIOLOS HC 26

TOTAL STORAGE CAPABILITY:	26 m³
THEORYC PRODUCTION:	480 kg/min
EMPTY PLANT WEIGHT:	6200 kg
ABSORBED POWER:	13 kW
THREE-PHASE TENSION FEEDING:	4000V, 50Hz

CARSIOLOS HC 36 (36 m³)

CARSIOLOS HC 36

TOTAL STORAGE CAPABILITY:	36 m³
THEORYC PRODUCTION:	480 kg/min
EMPTY PLANT WEIGHT:	7050 kg
ABSORBED POWER:	15 kW
THREE-PHASE TENSION FEEDING:	400V, 50Hz



CARMIX BAGGER

VERSATILITY AT WORK

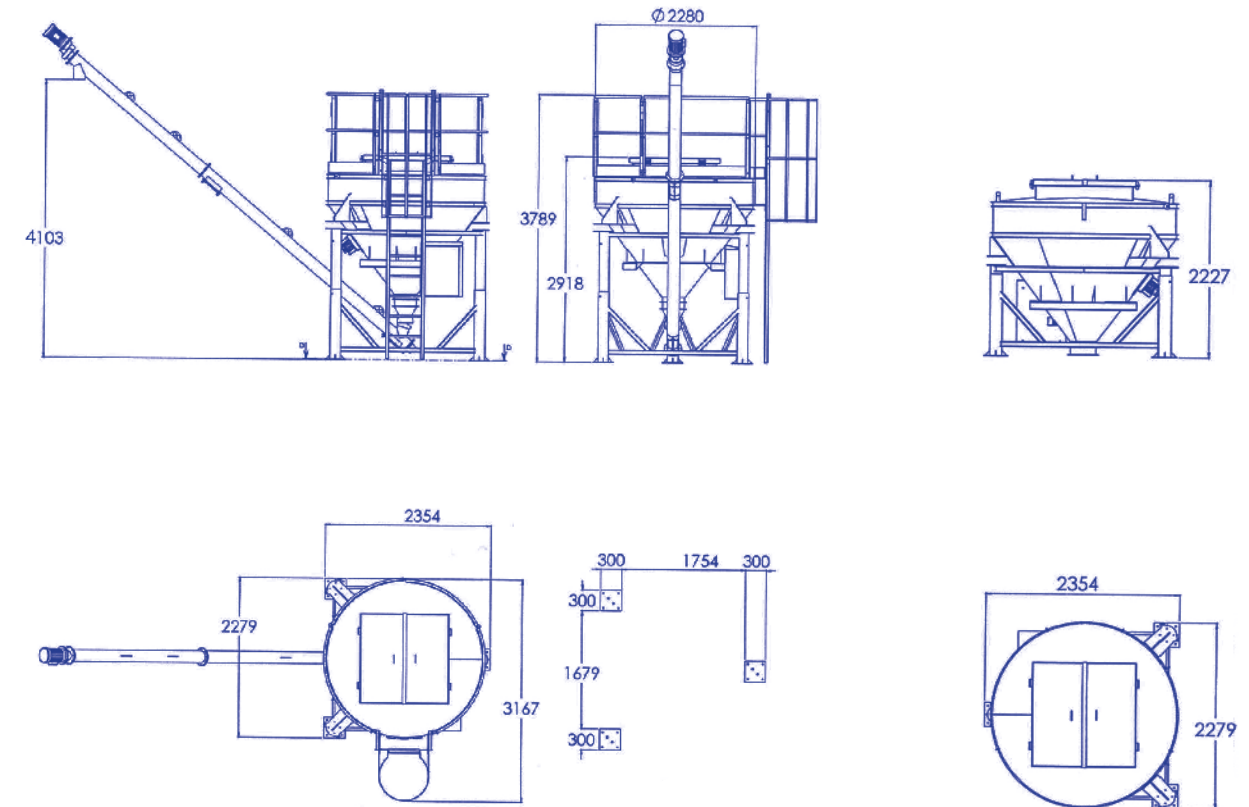

CARMIX BAGGER

- + Small silo for cement bags or big-bags with extractor screw
- + Electronic weighing system with load cells
- + Independent engine 5 kw
- + Electric control panel.
- + Vibrators, discharging screw conveyor, bag breaker, protection grid and ladder
- + Total storage 3 m³
- + Discharge auger flow 250 kg/min





NUMBER ONE FOR SATISFACTION

   #BeACarmixMan #BeACarmixWoman

Noventa di Piave (Venice) ITALY
T. +39 0421 65191 - info@carmix.com